

HOW TO USE

Connecteur Keystone RJ45 - no tools

CABLE PREPARATION

- Strip the cable for about 30mm. If it has a pair separator, cut it off. Also, remove individual foil shields if they are present. If the cable has a ground drain, fold it back onto the sheath.
- To maintain a 360° ground continuity, fold the general aluminum foil or braid back onto the cable sheath.

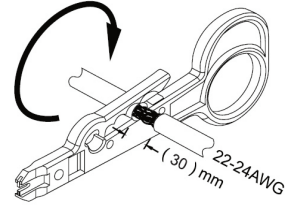

WIRE ORGANIZATION

- Select the cap suitable for the diameters of the cable wires.
GREEN CAP: AWG23 : Cat6, Cat6A, Cat7, GRADE 2TV
ORANGE CAP: AWG22 : Cat7A, GRADE 3 TV
- Thread the pairs through the center of the wiring cap.
- Arrange the wires according to the wiring convention.
- Position each wire in the designated «grooves» to hold them in position and trim the excess wires as short as possible.

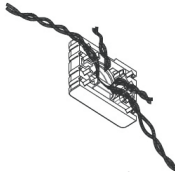

	TIA 568 A	TIA 568 B	PTT 298
1	White / Orange	White / Green	Grey
2	Orange	Green	White
3	White / Green	White / Orange	Rose
4	Blue	Blue	Orange
5	White / Blue	White / Blue	Yellow
6	Green	Orange	Bleu
7	White / Brown	White / Brown	Purple

ADJUSTING TO THE CONNECTOR

- Place the prepared cap onto the connector body using the Visual key (align the III symbol on the cap with the III symbol on the connector's body).

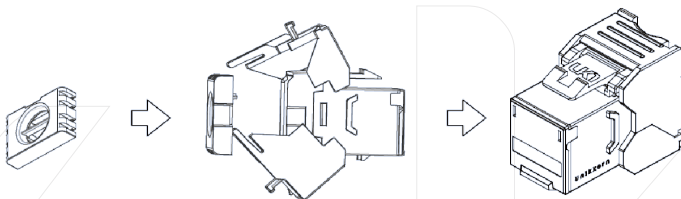

- Close the connector by pressing on both parts of the cover. The connection is made by pressure through the IDCs (Insulation-Displacement Contacts) for crimping.
- Place the ground drain, foil or braid in contact with the connector body, and secure it with the collar.