

# KSALCDX

LC Duplex Adapter Twin Core with short flange



## UNIK ✓

- ✓ Compact Design with short flange
- ✓ High-Precision Alignment
- ✓ Durable construction
- ✓ Integrated Mounting Clips

## THE PURPOSE

The UNIKKERN LC twin-core adapter with a short flange is designed to connect two LC duplex connectors, facilitating efficient fiber optic connections. Its compact design with a reduced flange size allows for higher-density installations, optimizing space within patch panels and enclosures. Equipped with zirconia ceramic alignment sleeves, it ensures precise mating of connectors, resulting in low insertion loss and reliable performance.

The adapter's lightweight and durable construction, often featuring integrated mounting clips, enables easy snap-in installation, simplifying the setup process.

## THE STRUCTURE

Mode	Housing Color
SM/PC	Blue RA 5015
SM/APC	Green RAL 6018
MM	Beige RAL 9001
OM3	Aqua RAL 6034
OM4	Magente RAL 4003
OM5	Lemon green Pantone 2300C

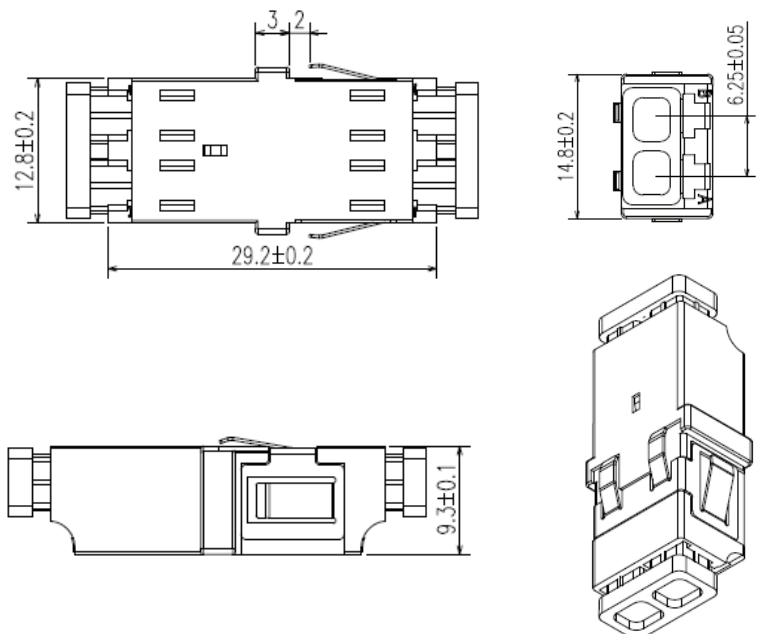

# KSASCDX

LC Duplex Adapter Twin Core with short flange

## PURCHASE INFO

Item	Designation	Packing
KSALCDM	LC Duplex Multimode Adapter	Eco bag of 40pcs
KSALCDS	LC Duplex Singlemode Adapter	Eco bag of 40pcs

## EXTRAS



### KSPLICE60MM

Splice protection heat shrinks 60mm



### KPIGxxxxxxMEF

Pigtails 2 meters eco friendly

